

SL. NO.	NAME OF ROOMS	FLOORING	SKIRTING	DADO	INTERNAL PLASTERING (WALL SURFACES)	EXTERNAL PLASTERING (WALL SURFACES)	PLASTERING ON CEILING INCLUDING SOFFIT OF SLABS, SIDES AND SOFFITS OF BEAMS ETC.	ROOF TREATMENT	INTERNAL WALL / SURFACES	INTERNAL CEILING INCLUDING SOFFIT OF SLAB SIDES AND SOFFIT OF BEAMS ETC.	EXTERNAL WALL / SURFACES	WOODEN SURFACES	STEEL SURFACES	REMARKS
EQUIPMENT TRAINING CLASSROOM BLOCK WITH TOILET														
GROUND FLOOR PLAN														
1	STEPS	GF-9	GF-9	-	IW-1	EW-1*	IW-4	-	IF-3(b)	IF-1	EF-3	WF-1	SF-1	
2	OPEN PLATFORM	GF-22(b)	SK-6	-	IW-1	EW-1*	IW-4	-	IF-3(b)	IF-1	EF-3	WF-1	SF-1	
3	VERANDAH	GF-22(b)	SK-6	-	IW-1	EW-1*	IW-4	-	IF-3(b)	IF-1	EF-3	WF-1	SF-1	
4	CLASS ROOMS	GF-22(b)	SK-6	-	IW-1	EW-1*	IW-4	-	IF-3(b)	IF-1	EF-3	WF-1	SF-1	
5	STAIRCASE	GF-9	GF-9	-	IW-1	EW-1*	IW-4	-	IF-3(b)	IF-1	EF-3	WF-1	SF-1	
6	TOILET	GF-5	-	D-3(c)	IW-1	EW-1*	IW-4	-	IF-3(b)	IF-1	EF-3	-	SF-1	
7	WC	GF-5	-	D-3(c)	IW-1	EW-1*	IW-4	-	IF-3(b)	IF-1	EF-3	-	SF-1	
8	SPACE FOR WATER COOLER	GF-22(b)	-	D-3(c)	IW-1	EW-1*	IW-4	-	IF-3(b)	IF-1	EF-3	-	SF-1	
FIRST FLOOR PLAN														
1	PASSAGE	UF-13(b)	SK-6	-	IW-1	EW-1*	IW-4	RF-1	IF-3(b)	IF-1	EF-3	WF-1	SF-1	
2	CLASS ROOMS	UF-13(b)	SK-6	-	IW-1	EW-1*	IW-4	RF-1	IF-3(b)	IF-1	EF-3	WF-1	SF-1	
3	STAIRCASE	UF-8	GF-8	-	IW-1	EW-1*	IW-4	RF-1	IF-3(b)	IF-1	EF-3	WF-1	SF-1	
4	TOILET	UF-4	-	D-3(c)	IW-1	EW-1*	IW-4	RF-1	IF-3(b)	IF-1	EF-3	-	SF-1	
5	WC	UF-4	-	D-3(c)	IW-1	EW-1*	IW-4	RF-1	IF-3(b)	IF-1	EF-3	-	SF-1	
6	SPACE FOR WATER COOLER	UF-13(b)	-	D-3(c)	IW-1	EW-1*	IW-4	RF-1	IF-3(b)	IF-1	EF-3	-	SF-1	

NOTES :-
 1. EW-1* SAME AS EW-1 BUT THICKNESS OF PLASTER IS 15MMIN TWO LAYER (10MM + 5MM) USING WATER PROOFING COMPOUND.

SL. NO.	NAME	SYMBOL
1.	LED TUBE LIGHT 1X20W	
2.	CEILING FAN 1200mm	
3.	EXHAUST FAN 300MM	
4.	6 AMP INDEPENDENT POINT	
5.	AC PLUG SOCKET	
6.	16 AMP INDEPENDENT POINT	
7.	BUILDING SECURITY LIGHT	
8.	TPN VERTICAL DB 4 WAY	
9.	TPN DB 4 WAY	

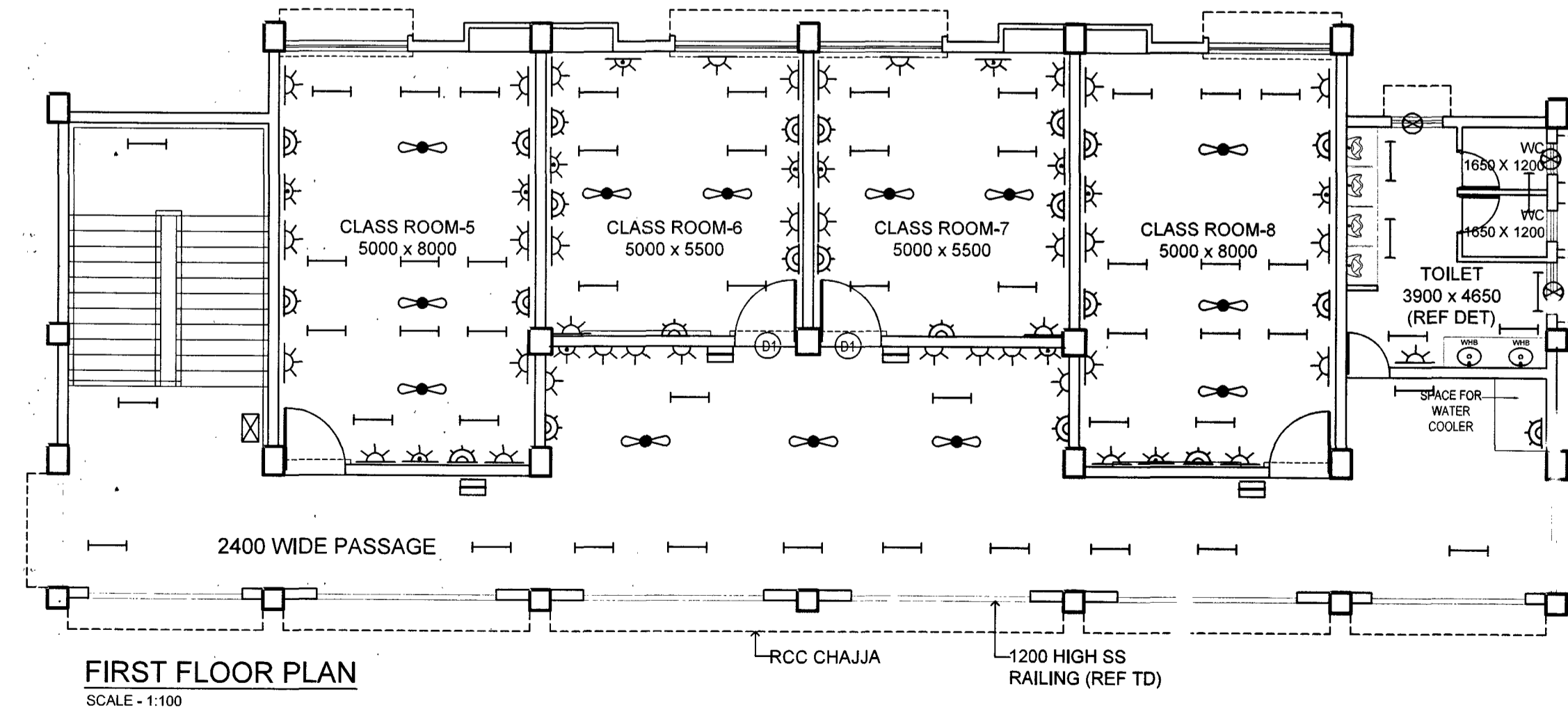
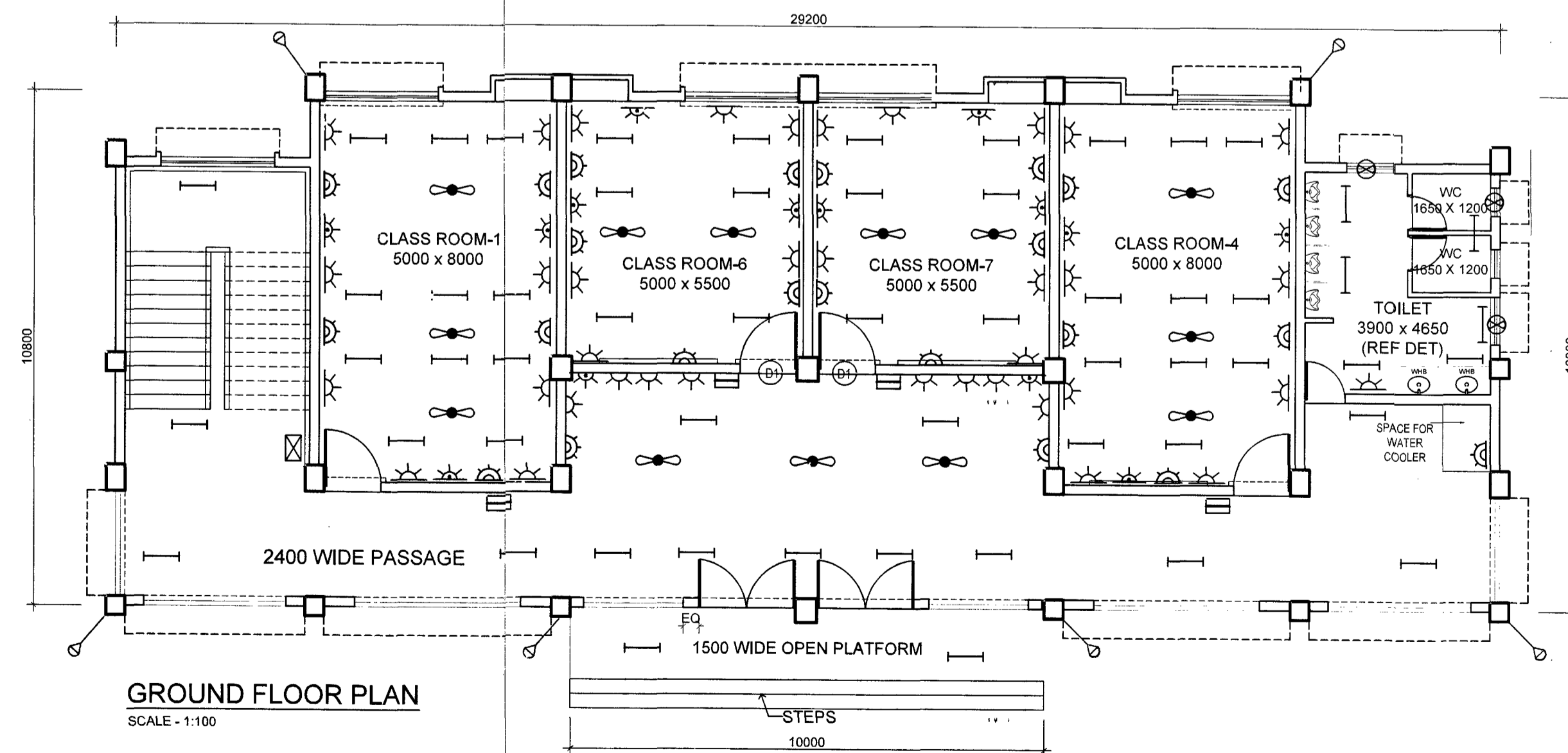

No.	Revision	Date	Sign
Project Name			
PROVN OF EQUIPMENT TRAINING CLASSROOM BLOCK WITH TOILET FOR MAC GP AT MIC&S AHMEDNAGAR			
SCHEDULE OF FINISHES AND INTERNAL ELECTRIFICATION			
DATE	19-MAR-2026	CHIEF ENGINEER	SHT NO
DRN	NB SUB WIND SINGH	PUNE ZONE	1/1
SCALE	AS SHOWN	DRG NO:-CEPZ/2026/ANR/SF & EM/06	
AAD (U)		DIRECTOR (PLG) & (U) FOR CHIEF ENGINEER	

ARCH-08-SUB-RAKESH MAHARAJWAR